

### IMPORTANT SAFETY INSTRUCTIONS

When using electrical appliances, especially when children are present, basic safety precautions should always be followed, including the following:

#### FOR HOUSEHOLD USE ONLY

#### READ ALL INSTRUCTIONS BEFORE USING—SAVE THESE INSTRUCTIONS

**Do not use this appliance near bathtubs, showers, basins or other vessels containing water.**

**▲ WARNING—To reduce the risk of death by electric shock:**

1. Always unplug the unit immediately after using.
2. Do not use while bathing.
3. Do not place or store appliance where it can fall or be pulled into a bath or sink.
4. Do not place in or drop into water or other liquid.
5. If an appliance falls into water, unplug immediately before removing the appliance. Do not reach into the water.

**▲ WARNING—To reduce the risk of burns, electrocution, fire or injury to persons:**

6. An appliance should never be left unattended when plugged in. When the appliance is used in a bathroom, unplug it after use since the proximity of water presents a hazard even when the appliance is switched off.
7. Cleaning and maintenance should not be done by children without supervision.
8. This appliance is not intended for use by persons (including children) with reduced physical, sensory or mental capabilities, or lack of experience and knowledge, unless they have been given supervision or instruction concerning use of the appliance by a person responsible for their safety.
9. Children should be supervised to ensure that they do not play with the appliance.
10. Use this appliance only for its intended use as described in this manual.
11. For safety, only use Shark attachments with this product.
12. For additional protection, the installation of a residual current device (RCD) having a rated residual operating current not exceeding 30 Ma is advisable in the electrical circuit supplying the bathroom. Ask your installer for advice.

13. Never operate this appliance if it has a damaged cord or plug, if it is not working properly or if it has been dropped, damaged or dropped into water, contact Shark customer service center.
14. Keep the cord away from heated surfaces. Do not wrap the cord around the appliance.
15. Never block the air openings of the appliance or place it on a soft surface, such as a bed or sofa, where the air openings may be blocked. Keep the air openings free of lint, hair and the like.
16. Never use on someone who is sleeping.
17. Never drop or insert any object into any opening.
18. Do not use outdoors or operate where aerosol (spray) products are being used or where oxygen is being administered.
19. Do not use an extension cord with this appliance.
20. Do not direct hot air toward eyes or other heat-sensitive areas.
21. Attachments may be hot during use. Allow them to cool before handling.
22. Do not place appliance on any surface while it is operating.
23. While using the appliance, keep your hair away from the air inlets.
24. Do not operate with a voltage converter.
25. For skus that include a storage case, storage case is not heat resistant.
26. Do not use this appliance on hair extensions or wigs unless recommended by the hair extension or wig manufacturer.
27. If hair styling product is being used in conjunction with this appliance please read and follow all of the hair styling product safety warnings and instructions before use.

**TECHNICAL SPECIFICATIONS** Voltage: 220-240V, 50-60Hz | Power: 1400W

©2022 SharkNinja Operating LLC.

SHARK FLEXSTYLE is a trademark in Australia and New Zealand of SharkNinja Operating LLC.

For accessories and replacement parts, visit

[sharkclean.com.au](http://sharkclean.com.au)

[sharkclean.co.nz](http://sharkclean.co.nz)

HD440ANZ\_Series\_Warning\_Insert\_MP\_Mv2\_221201

# TWO (2) YEAR LIMITED GUARANTEE

---

The warranty commences on the date of purchase and expires at the end of the two-year period. In the unlikely event of a defect due to faulty materials or workmanship within the guarantee period we will replace the defective/faulty part with a new product, free of charge, or if the unit is deemed defective/faulty we replace the unit with an equivalent or upgraded model, at our discretion.

For warranty claims, you will need to submit a proof of purchase in the form of a valid receipt that displays date and place of purchase.

## **Your warranty is subject to the following conditions**

- DO NOT operate the appliance with a damaged plug or cord, or if the unit has been dropped, damaged or dropped in water.
- To avoid the risk of electric shock, do not disassemble or attempt to repair the appliance on your own. If the supply cord is damaged, it must be replaced by a qualified electrician to avoid a hazard. Incorrect re-assembly or repair can cause a risk of electric shock or injury to persons when the appliance is used.
- The item has not been misused, abused, neglected, altered, modified or repaired by anyone.
- The item has been subjected to fair wear and tear.
- The item has not been used for trade, professional or hire purposes.
- The item has not sustained damage through foreign objects, substances or accident

## **Customer costs within warranty**

The customer is responsible for any inwards freight charge to return a product for warranty if requested, and outward freight charge for warranty parts and or replacement unit.

## **Who is covered?**

This warranty applies only to the original purchaser, who bought the product from an authorised retailer and may not be transferred. Proof of purchase is required.

## **What is not covered?**

- Filters and brush rolls
- Accessories supplied with the item.
- Components that are subject to natural wear and tear caused by normal use in accordance with operating instructions.
- Unauthorised/improper maintenance/handling or overload is excluded from this warranty.
- Accidental damage
- Damage as a result of use not in accordance with the rating plate
- Removal of blockages. If a blockage does occur please refer to the trouble shooting guide within your Shark Operating manual
- Use of parts and accessories that are not genuine Shark components

# OPERATING INSTRUCTIONS

1. Turns the styler on and off.
  2. Adjusts the airflow. Pressing the button allows you to choose a low, medium, or high airflow.
  3. Adjusts the temperature. Pressing the button allows you to choose no heat, low, medium or high temperature.
  4. Press and hold the Cool Shot button for a cool burst of air to set your style.
  5. To attach any accessories included with your model, press them into the nozzle outlet. You will know they are properly attached when they click in place.
  6. To remove any accessories included in your model, slide the lock down and lift the accessory off of the nozzle by holding onto the touchpoints identified in your Style Guide.
  7. To change from styling wand mode to hair dryer mode, slide down the lock and rotate the nozzle left.
- Keep rotating the nozzle until it clicks into place in hair dryer mode. To change from hair dryer mode to styling wand mode, slide down the lock and rotate the nozzle right.
8. To remove the filter cover, slide it off the bottom of the unit. To attach filter cover, slide it back on to the bottom of the unit until it clicks in place.

**For further operating instructions, please consult the Styling Guide.**

## **Storage, Cord Safety, and Maintenance/Cleaning:**

- Ensure the cord is not knotted, twisted, or wrapped around any nearby objects when in use.
- Store the unit in a dry location away from water and other heat sources.
- Regularly clean the filter at the bottom of the unit.

To clean the filter, first slide the filter cover off the bottom of the unit. Then use a new toothbrush to brush off any dust or debris on the filter. Once the filter is clean, slide the filter cover back onto the unit until it clicks in place.

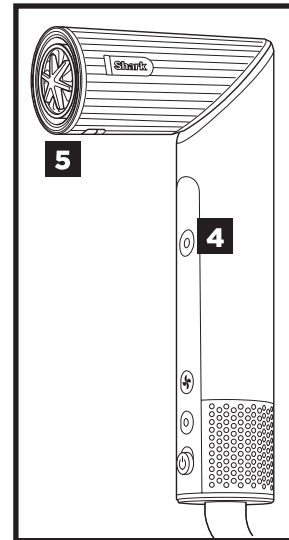
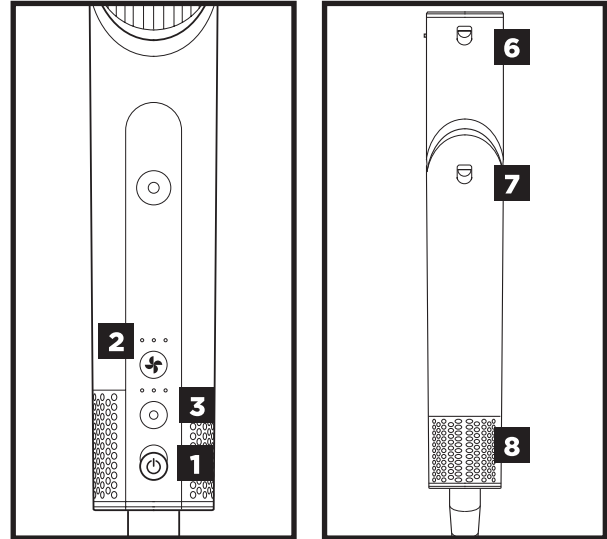

# TROUBLESHOOTING & ERROR CODES

## MAINTENANCE/CLEANING

### Reduction in Airflow, Overheating

A change in airflow or air power, airflow blockages, and/or visible buildup on the inlet at the bottom of the unit indicates your unit needs to be cleaned. We recommend using a new toothbrush to clean off the filter at the bottom of the unit.

## OVERHEATING

### Hair dryer is overheating or shuts off.

This unit is equipped with a temperature-protective thermostat. If for some reason your hair dryer overheats, the thermostat will automatically turn the unit off. To prevent power-down recurrence, unplug the hair dryer and set it aside to cool, or cool down using the cool shot button during use. Overheating may result if the unit is powered on for a long duration, or can indicate a blockage or dust buildup.

We recommend using a new toothbrush to clean off the filter at the bottom of the unit. If overheating continues to occur, contact Customer Service at

**AUS: +61 2 8801 7666**

**NZ: +64 800 112 660**

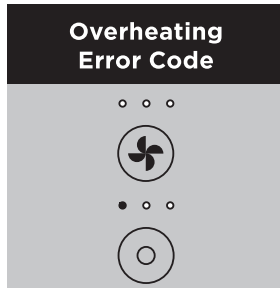

If you are experiencing a different error code, contact Customer Service at

**AU: +61 2 8801 7666**

**NZ: +64 800 112 660**

Mann & Noble Pty Ltd

Building D

33 Quarry Road

Erskine Park

NSW, Australia, 2759

AUS +61 2 8801 7666

NZ +64 800 112 660

[www.sharkclean.com.au](http://www.sharkclean.com.au)

[www.sharkclean.co.nz](http://www.sharkclean.co.nz)



E4156

