

# Shark™

**Steam Mop**

**S1000SM**

**INSTRUCTIONS**

 sharkclean.my

 +60 1800 803 915

 sharkclean.sg

 +65 800 120 5111



# THANK YOU

for purchasing the Steam Mop.

## REGISTER YOUR PURCHASE

 sharkclean.my

 MY +60 1800 803 915

 sharkclean.sg

 SG +65 800 120 5111

## RECORD THIS INFORMATION

Model Number: \_\_\_\_\_

Date Code: \_\_\_\_\_

Date of Purchase (Keep receipt): \_\_\_\_\_

Store of Purchase: \_\_\_\_\_

## TECHNICAL SPECIFICATIONS

Voltage: 220-240V~, 50-60Hz

Watts: 1050W

Water Capacity: 375ml

## PLEASE READ CAREFULLY AND KEEP FOR FUTURE REFERENCE.

This instruction manual is designed to help you get a complete understanding of your new Steam Mop.

If you have any questions, please call the Customer Service line at SG +65 800 120 5111  
MY +60 1800 803 915.

# CONTENTS

<b>Important safety instructions</b> .....	<b>3</b>
<b>Getting to know your Steam Mop</b> .....	<b>5</b>
<b>Assembling your Steam Mop</b> .....	<b>6</b>
<b>Using your Steam Mop</b> .....	<b>7</b>
To sanitise with your Steam Mop .....	10
<b>Accessories</b> .....	<b>11</b>
<b>Maintaining your Steam Mop</b> .....	<b>12</b>
After use and storage .....	12
<b>Troubleshooting Guide</b> .....	<b>13</b>
<b>Warranty</b> .....	<b>14</b>

# IMPORTANT SAFETY INSTRUCTIONS

FOR HOUSEHOLD USE ONLY

## ⚠️ WARNING

To reduce the risk of injury, fire, electric shock and property damage resulting from improper use of the appliance, carefully observe the following instructions. This unit contains electrical connections and moving parts that potentially present risk to the user.



### DANGER OF SCALDING: THE STEAM EMITTED FROM THE STEAM MOP IS VERY HOT AND MAY CAUSE SCALDING. PLEASE USE CAUTION WHEN USING THE STEAM MOP.

- 1 This appliance can be used by persons with reduced physical, sensory or mental capabilities or lack of experience and knowledge if they have been given supervision or instruction concerning use of the appliance in a safe way and understand the hazards involved. Children shall not play with the appliance.
- 2 Keep the appliance out of reach of children when it is energised or cooling down.
- 3 When in use, **NEVER** turn the Steam Mop over on its side or direct steam toward people, pets or plants. Liquid or steam must not be directed towards equipment containing electrical components, such as the interior of ovens.
- 4 The filling aperture shall not be opened during use.
- 5 Use the system **ONLY** for its intended purpose.
- 6 **DO NOT** use to heat a room.
- 7 **DO NOT** use outdoors.
- 8 **DO NOT** leave the Steam Mop unattended when plugged in. **ALWAYS** unplug the power cord from the electrical socket when not in use and before servicing.
- 9 **DO NOT** allow the Steam Mop to be used by children. Close attention is necessary when used near children, pets or plants.
- 10 Use **ONLY** as described in this instruction manual.
- 11 Use **ONLY** manufacturer's recommended accessories.
- 12 **DO NOT** use with damaged cord or plug. If the Steam Mop is not working as it should or has been dropped, damaged, left outdoors or immersed in water, return it to SharkNinja Operating LLC for examination and repair. Incorrect reassembly or repair can cause a risk of electrical shock or injury when the Steam Mop is used.
- 13 To protect against a risk of electric shock, **DO NOT** immerse the Steam Mop in water or any other liquid.
- 14 **DO NOT** handle the plug or Steam Mop with wet hands or operate it without wearing shoes.
- 15 **DO NOT** pull or carry by cord, use cord as a handle, close a door on cord or pull cord around sharp edges or corners. **DO NOT** run Steam Mop over cord. Keep cord away from heated surfaces.

# SAVE THESE INSTRUCTIONS

PLEASE READ CAREFULLY BEFORE USE

- 16 **DO NOT** unplug by pulling on power cord. To unplug, grasp the plug, not the power cord. **DO NOT** use extension cords or sockets with inadequate current-carrying capacity.
- 17 **DO NOT** put any objects into the steam nozzle openings. Discontinue use if the steam nozzle is blocked.
- 18 **DO NOT** put hands or feet under the Steam Mop. It gets very hot.
- 19 Use **ONLY** on flat, horizontal surfaces. **DO NOT** use on walls, counters or windows.
- 20 **DO NOT** use on leather, wax-polished furniture, synthetic fabrics, velvet or other delicate, steam-sensitive materials.
- 21 **DO NOT** add cleaning solutions, vinegar, scented perfumes, oils or any other chemicals to the water used in the Steam Mop as this may damage it or make it unsafe for use. If you live in a hard-water area, we recommend using distilled water in your Steam Mop.
- 22 **NEVER** store or leave Steam Mop in one spot with Dirt Grip™ pad attached, as this may damage surfaces.
- 23 Before removing Dirt Grip pad, unplug the Steam Mop and allow it to cool.
- 24 Unplug the Steam Mop before cleaning. Use a dry or damp cloth to clean the exterior. **DO NOT** pour water on Steam Mop or use alcohol, benzene or paint thinner to clean.
- 25 Extreme caution should be exercised when using the Steam Mop to clean stairs.
- 26 **NEVER** use Steam Mop without the Dirt Grip pad attached.
- 27 Keep your work area well lit.
- 28 Store Steam Mop indoors in a cool, dry place.
- 29 To avoid circuit overload, **DO NOT** operate another appliance on the same socket (circuit) as the Steam Mop.
- 30 To avoid scalding injuries, **ALWAYS** unplug the Steam Mop and allow it to cool before removing or changing mop heads, accessories or Dirt Grip pads.
- 31 Your Steam Mop is designed to clean hard floor surfaces that will withstand high heat. **DO NOT** use on unsealed wood or unglazed ceramic floors. On surfaces that have been treated with wax and on some no-wax floors, the sheen may be removed by the heat and steam action. We recommend testing an isolated area of the surface to be cleaned before proceeding. We also recommend that you check the use and care instructions from the floor manufacturer.

## GETTING TO KNOW YOUR STEAM MOP

### WELCOME!

Congratulations on your purchase. Use this instruction manual to learn about your new Steam Mop's great features. From assembly to use to maintenance, you will find it all in here.

**NOTE:** When assembling your Steam Mop there may be a little water in or around the water tank. This is because we thoroughly test all of our Steam Mops before you buy them, so you get a quality Steam Mop.

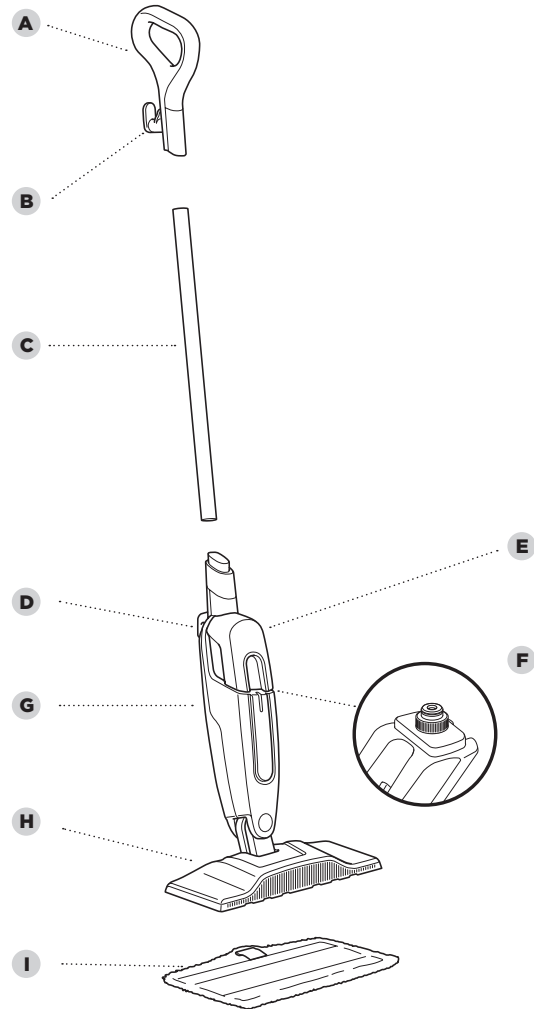

### MAIN UNIT

- |                               |                         |
|-------------------------------|-------------------------|
| <b>A</b> Steam Mop Handle     | <b>F</b> Water Tank Cap |
| <b>B</b> Upper Cord Wrap      | <b>G</b> Steam Mop Body |
| <b>C</b> Pole                 | <b>H</b> Mop Head       |
| <b>D</b> Lower Cord Wrap      | <b>I</b> Dirt Grip™ Pad |
| <b>E</b> Removable Water Tank |                         |

## ASSEMBLING YOUR STEAM MOP

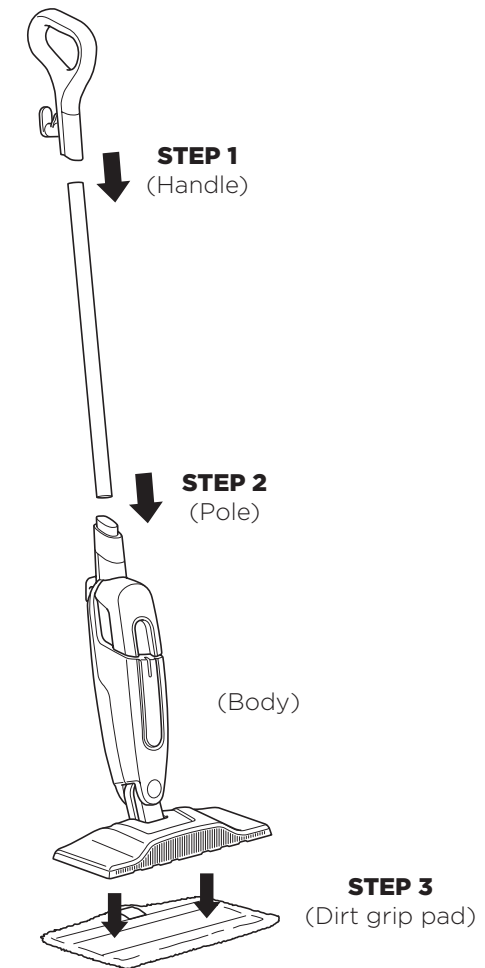

- 1 Align the mop handle and mop pole so the arrow symbols inside them face forward. Insert either end of the pole into the handle until it clicks securely into place.
- 2 Align the assembled steam mop pole and the steam mop body, so their arrow symbols both face forward. Insert the pole into the top of the mop body, sliding it in until it clicks into place.
- 3 Place the Dirt Grip™ cleaning pad on the floor with the quick fastener strips facing up. Align the mop head directly over the pad, then press the mop head down onto the pad. The quick fastener strips will secure the pad to the mop head.

## USING YOUR STEAM MOP

★ **IMPORTANT: DO NOT scrub any one area for an extended period of time.**

★ **IMPORTANT:** Before you fill up the tank, make sure your Steam Mop is unplugged from the electrical socket.

★ **IMPORTANT:** Make sure you **DO NOT** use the Steam Mop without first attaching a Dirt Grip™ pad and filling the tank with water.

**NOTE:** To prolong the life of your Steam Mop, we recommend using distilled water.

**NOTE:** Sweep or vacuum your floors prior to cleaning with your Steam Mop.

**NOTE:** Please wait 2 to 3 minutes for the Steam Mop to cool off before removing the Dirt Grip pad. **NEVER** leave the Steam Mop with a damp or wet Dirt Grip pad on any floor for an extended period of time.

### STEP 1

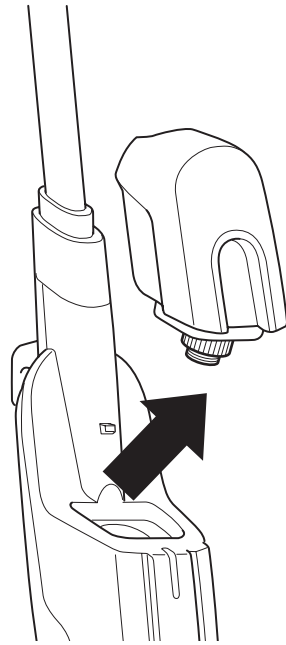

- 1 To remove the tank, lift it up and away from the Steam Mop body. Make sure to unplug the Steam Mop before removing the water tank.

### STEP 2

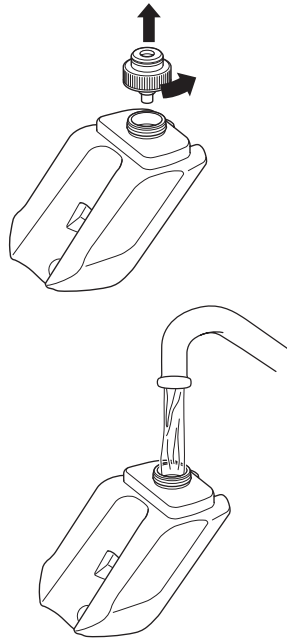

- 2 To remove the water tank cap, twist counterclockwise. Fill tank completely with distilled water or tap water.

### STEP 3

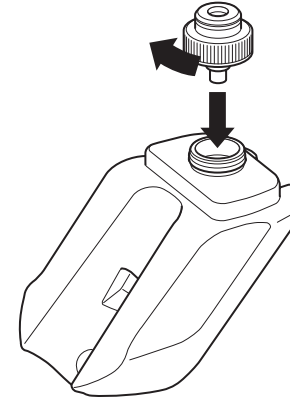

- 3 Replace cap on water tank and turn cap clockwise to seal.

### STEP 4

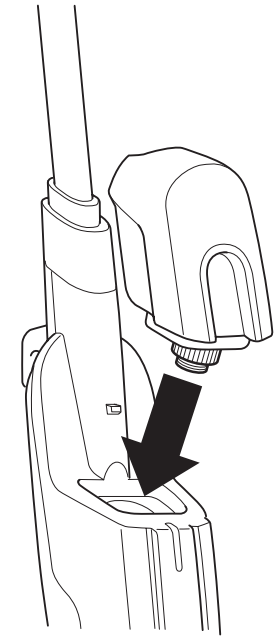

- 4 To replace the water tank, align it so the cap faces down. Place the cap into the hole in the Steam Mop body and slide tank down until it clicks securely into place.

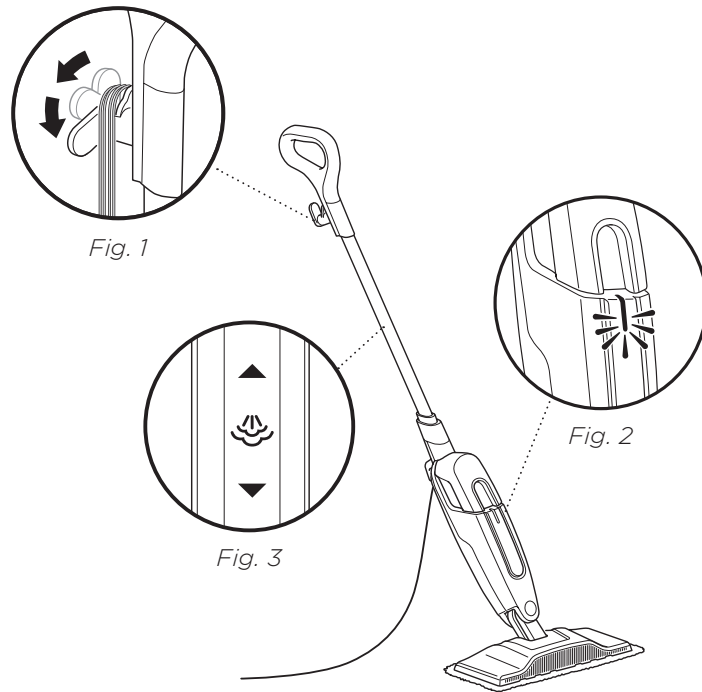

- 1** Pull and twist the quick release cord holder to unwrap the power cord completely (Fig. 1). When Steam Mop is plugged into an electrical socket, the power light will illuminate (Fig. 2). It takes approximately 30 seconds for the mop to heat up and the steam to be ready.
- 2** Pump the handle a few times in a downward motion (Fig. 3) This pumping action will release steam as you mop and allows you to customise the amount of steam you want. Begin mopping with a forward and backward motion. The natural motion of mopping will produce steam.
- 3** When the water tank is empty, the Steam Mop will stop producing steam. Make sure to unplug the Steam Mop before refilling the water tank. Follow the water tank refilling instructions on pages 7-8.

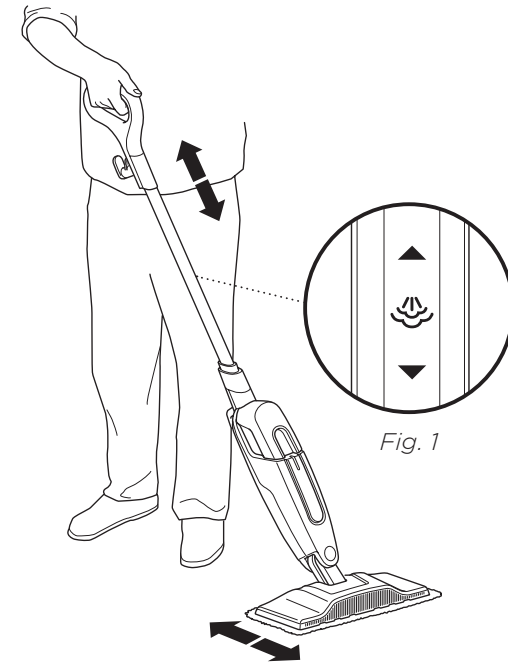

### TO SANITISE\* WITH YOUR STEAM MOP

- 1** Start with a clean pad.
- 2** Pump the handle a few times in a downward motion (Fig. 1).
- 3** Start mopping on an appropriate sealed hard-floor surface with a forward and backward motion. After three minutes, your unit is ready to be used to sanitise.
- 4** Using a forward and backward motion, move the unit over the area you seek to sanitise. Repeat at least 15 times.

\*Sanitisation studies were conducted under controlled test conditions. Household conditions and results may vary.

## ACCESSORIES

Refer to the packaging which shows the select accessories that are included with your model.

To purchase additional accessories, visit [sharkclean.sg](http://sharkclean.sg) or [sharkclean.my](http://sharkclean.my)

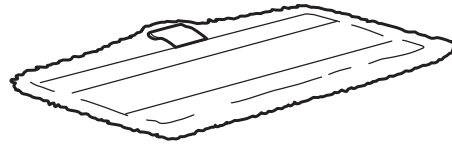

### DIRT GRIP™ WASHABLE PAD

These easy-to-attach, reusable pads feature a super-absorbent microfibre for locking in moisture and dirt and scrubbing material for breaking up tough, stuck-on stains.

### PAD CARE INSTRUCTIONS

Machine-wash the Dirt Grip pads separately with warm water using liquid detergent.

**NEVER USE BLEACH, POWDERED DETERGENT or FABRIC SOFTENERS** as they may damage or leave a coating on the Dirt Grip pads that will reduce their cleaning performance and absorbency. Dirt Grip pads should be line-dried or tumble-dried on a low setting, as this will extend the life of the microfibre fabric.

Loose fibres can indicate wearing of the microfibre fabric. **DO NOT** pull the loose fibres, as this can cause the weave to come undone. Simply trim the loose fibres with scissors.

For best cleaning results, we recommend replacing your Dirt Grip pads every 3 to 4 months following normal use. As with any fabric, dirt particles, grease, friction and repeated washing can cause the fibres to break down and you may notice an increase in the effort needed to push or pull the mop.

## MAINTAINING YOUR STEAM MOP

**⚠ WARNING:** To reduce the risk of shock and unintended operation, unplug unit before servicing.

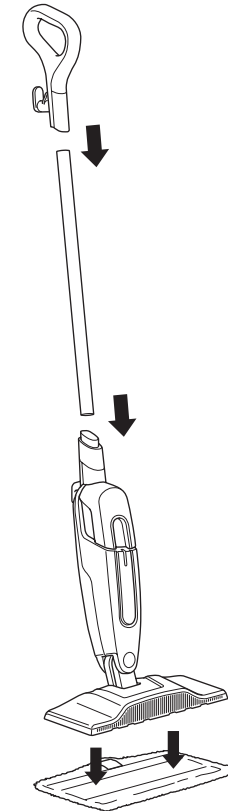

### AFTER USE AND STORAGE

- 1 Unplug the cord from the wall socket and wrap the cord around the cord hooks. Lock the Steam Mop in an upright standing position by raising the handle until the pole is standing straight up, perpendicular to the ground.
- 2 After cleaning, wait 2 to 3 minutes to let the Dirt Grip™ pad cool before touching it. When cool, remove pad from mop head to avoid damage to your floors. Remove the pad by stepping on the tab and lifting off the mop head or by carefully pulling the pad off the mop head.
- 3 With the unit locked in the upright standing position, store it in a cupboard or the corner of a room.

**⚠ WARNING: To reduce the risk of shock and unintended operation, turn off power and unplug unit before servicing.**

### **The Steam Mop will not turn on.**

- Your Steam Mop should be securely plugged into an electrical socket.
- Check your fuse or circuit-breaker.
- If your unit still doesn't work, give us a call at: +65 800 120 5111.

### **Steam Mop will not make steam.**

- Make sure there is water in the tank. To add water, follow the instructions on pages 7 and 8.
- If your water tank is full, prime the mop by pumping the handle in a downward motion a few times to release steam.

### **Steam Mop leaves water on the floor.**

- **DO NOT** leave the Steam Mop on the floor with a damp or wet cleaning pad.
- If you are using tap water, we recommend switching to distilled water.
- Make sure that the cap is securely placed on the water tank.

### **Steam Mop left white spot on the floor.**

- **DO NOT** leave the Steam Mop on the floor with a damp or wet cleaning pad.
- Do you have hard water? If you do, you might want to switch to distilled water.

### **Floors are cloudy, streaky or spotty after steaming.**

- The Dirt Grip™ pad might be dirty. Change to a new pad.
- If you washed the pad with powder detergent then the pad might have residual detergent left on it. Wash it again with liquid detergent.
- If you are cleaning in a kitchen area where there might be a buildup of grease, then use a degreasing agent such as an all-purpose cleaner or dish soap and paper towels to clean the area first.
- You might have left the mop in the same spot for too long.
- Do you have hard water? If you do, you might want to switch to distilled water.
- This might be left over from past cleaners used on the floor surface. Clean with the Steam Mop a few more times and see if the leftover cloudiness is removed.

### **Steam Mop is hard to push.**

- Make sure the Dirt Grip pad is properly attached.

### **Two (2) YEAR LIMITED REPLACEMENT WARRANTY**

The warranty commences on the date of purchase and expires at the end of the two-year period. In the unlikely event of a defect due to faulty materials or workmanship within the guarantee period we will replace the defective/faulty part with a new product, free of charge, or if the unit is deemed defective/faulty we replace the unit with an equivalent or upgraded model, at our discretion.

For warranty claims, you will need to submit a proof of purchase in the form of a valid receipt that displays date and place of purchase.

### **Your warranty is subject to the following conditions**

- **DO NOT** operate the appliance with a damaged plug or cord, or if the unit has been dropped, damaged or dropped in water.
- To avoid the risk of electric shock, do not disassemble or attempt to repair the appliance on your own. If the supply cord is damaged, it must be replaced by a qualified electrician to avoid a hazard. Incorrect re-assembly or repair can cause a risk of electric shock or injury to persons when the appliance is used.
- The item has not been misused, abused, neglected, altered, modified or repaired by anyone.
- The item has been subjected to fair wear and tear.
- The item has not been used for trade, professional or hire purposes.
- The item has not sustained damage through foreign objects, substances or accident

### **Customer costs within warranty**

The customer is responsible for any inwards freight charge to return a product for warranty if requested, and outward freight charge for warranty parts and or replacement unit.

### **Who is covered?**

This warranty applies only to the original purchaser, who bought the product from an authorised retailer and may not be transferred. Proof of purchase is required.

### **What is not covered?**

- Filters and brush rolls
- Accessories supplied with the item.
- Components that are subject to natural wear and tear caused by normal use in accordance with operating instructions.
- Unauthorised/improper maintenance/handling or overload is excluded from this warranty.
- Accidental damage
- Damage as a result of use not in accordance with the rating plate
- Removal of blockages. If a blockage does occur please refer to the trouble shooting guide within your Shark Operating manual
- Use of parts and accessories that are not genuine Shark components





**NOTE:** Save these instructions. Keep for future reference.



This marking indicates this product should not be disposed of with other household wastes throughout the EU. To prevent possible harm to the environment or human health from uncontrolled waste disposal, recycle it responsibly to promote the sustainable reuse of material sources. To return your used device, please use the return and collection systems or contact the retailer where this product was purchased. They can take this product for environmentally safe recycling.

**Mann & Noble Retail Brands Singapore  
Pte Ltd  
600 North Bridge Road  
#23-01 Parkview Square  
Singapore 188778**

**Mann & Noble Retail Brands Malaysia  
SDN. BHD.  
23-8, Menara Permata Damansara  
NO.685, Jalan Damansara  
60000 Kuala Lumpur  
Wilayah Persekutuan, Malaysia**

Illustrations may differ from actual product. We are constantly striving to improve our products, therefore the specifications contained herein are subject to change without notice.

©2021 SharkNinja Operating LLC.  
DIRT GRIP and SHARK are trademarks of SharkNinja Operating LLC.

